

COUNTY	STATE AID PROJ. NO.	FISCAL YEAR	PREF. NO.	TOTAL SHEETS
COFFEE	1	1917	1	16

INDEX OF SHEETS

SHEET No.	TITLE PAGE
1	TITLE PAGE
2	TYPICAL CROSS-SECTION OF IMPROVEMENT D-0-14
3	PLAN AND PROFILE, STA. 1+00 TO STA. 30+00
4	" " " " 30+00 " " 60+00
5	" " " " 60+00 " " 90+00
6	" " " " 90+00 " " 120+00
7	" " " " 120+00 " " 150+00
8	" " " " 150+00 " " 180+00
9	" " " " 180+00 " " 210+00
10	" " " " 210+00 " " 240+00
11	" " " " 240+00 " " 270+00
12	" " " " 270+00 " " 300+00
13	" " " " 300+00 " " 330+00
14	" " " " 330+00 " " 360+00
15	STANDARD CONCRETE BOX CULVERTS D-0-8
16	PIPE CULVERTS & CONCRETE ENDWALLS D-0-13

STATE OF TENNESSEE
DEPARTMENT OF HIGHWAYS

PLAN AND PROFILE OF PROPOSED
STATE HIGHWAY

STATE AID PROJECT

COFFEE COUNTY
FROM FRANKLIN CO. LINE TO MOORE CO. LINE

SR 16

SCALES { PLAN, 1 IN. = 100 FT.
PROFILE, HOR. 1 IN. = 100 FT., VERT. 1 IN. = 10 FT.

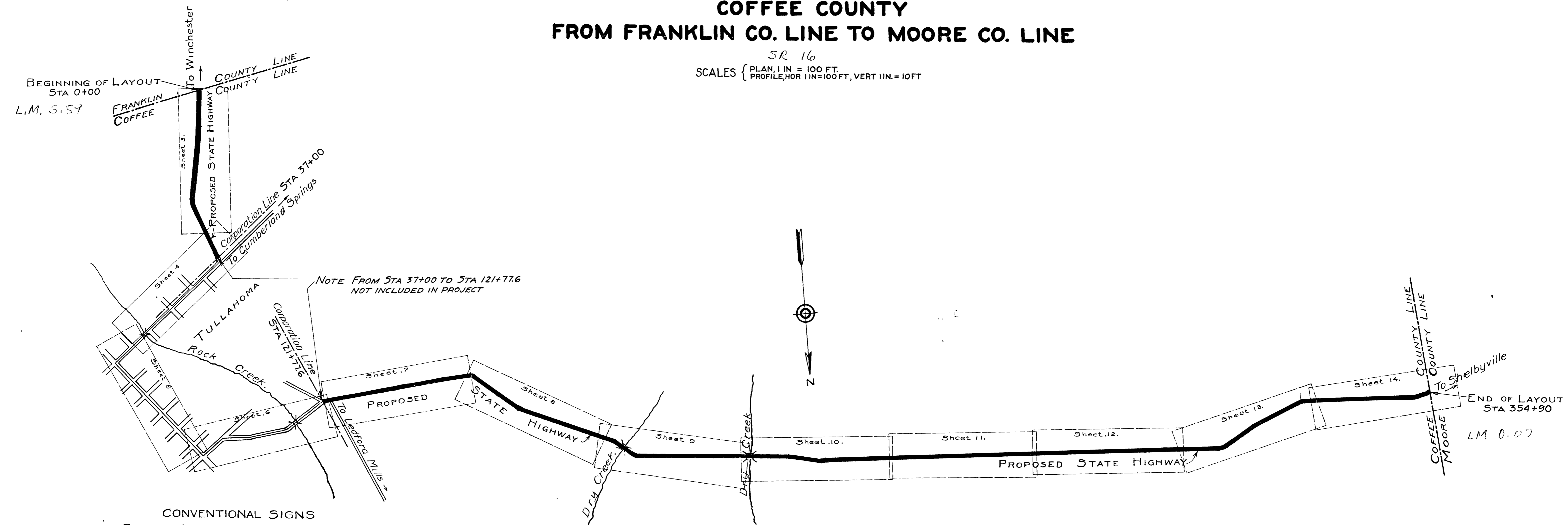

CONVENTIONAL SIGNS

COUNTY LINE	---
CITY CORPORATION LINE	----
PROPERTY LINE	-----
RIGHT OF WAY LINE	-----
TRAVELED WAY	-----
BASE OR SURVEY LINE	-----
CULVERTS	-----
BRIDGES	-----
GROUND ELEVATION	-----
GRADE ELEVATION	-----

LAYOUT
SCALE 1 IN. = 1000 FT.

TOTAL NET LENGTH 5.113 MI
TOTAL GROSS LENGTH 6.717 MI
4.38

APPROVED *A.M. Nelson*
STATE HIGHWAY ENGINEER
APPROVED *J. J. ...*
SECRETARY