

REVISIONS	
FEATURE	DATE
UPDATED USING INFORMATION PROVIDED BY LOCAL OFFICIALS	2002

**LEGEND**

- SCHOOL
- HOSPITAL
- POST OFFICE
- COURTHOUSE
- CITY HALL OR COMMUNITY CENTER
- MONUMENT
- AIRPORT , COMPLETE FACILITIES
- AIRPORT , LIMITED FACILITIES
- LANDING AREA OR STRIP
- OBSERVATION OR LOOKOUT TOWER
- ARMORY
- HIGHWAY GARAGE (S-STATE , C-COUNTY)
- POINTS OF INTEREST
- INTERSTATE HIGHWAY
- U S NUMBERED HIGHWAY
- STATE HIGHWAY
- LAKE WITH DAM
- RESERVOIR , POND OR LAKE
- LEVEE OR DYKE
- NARROW STREAM
- WIDE STREAM
- DAM WITH LOCK
- HEAD OF NAVIGATION
- NAVIGABLE STREAM
- GRADE CROSSING
- UNDERPASS-ROAD BELOW
- OVERHEAD-ROAD ABOVE
- RAILROAD TUNNEL
- GRADE SEPARATION
- FORD
- LOW WATER BRIDGE
- FREE FERRY OR TOLL FERRY
- HIGHWAY BRIDGE-OVER 20 FEET
- HIGHWAY BRIDGE-LONG RIVER CROSSING
- PRIMITIVE OR UNIMPROVED ROAD
- GRADED AND DRAINED, SOIL, GRAVEL OR STONE SURFACED ROAD
- PAVED ROAD
- GRADED AND DRAINED, SOIL, GRAVEL OR STONE SURFACED HIGHWAY
- PAVED HIGHWAY
- DIVIDED ROADWAY
- \* 0.52 \* (FCA)
- (NPS)
- NATIONAL PARK SERVICE HIGHWAY
- COUNTY LINE
- STATE LINE
- INCORPORATED CITY BOUNDARY
- RESERVATION BOUNDARY

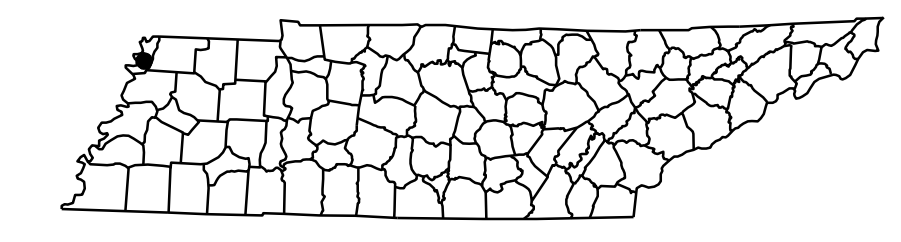

CITY MAP

**RIDGELY**  
LAKE COUNTY  
**TENNESSEE**

PREPARED BY THE  
**TENNESSEE DEPARTMENT OF TRANSPORTATION**  
LONG RANGE PLANNING DIVISION  
IN COOPERATION WITH THE  
U.S. DEPARTMENT OF TRANSPORTATION  
FEDERAL HIGHWAY ADMINISTRATION

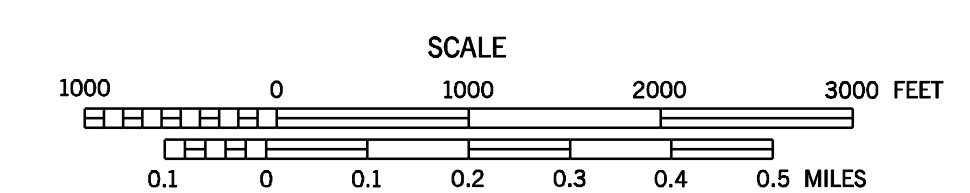

**2002**

AUTHORIZATION NO. 40/90102/4802

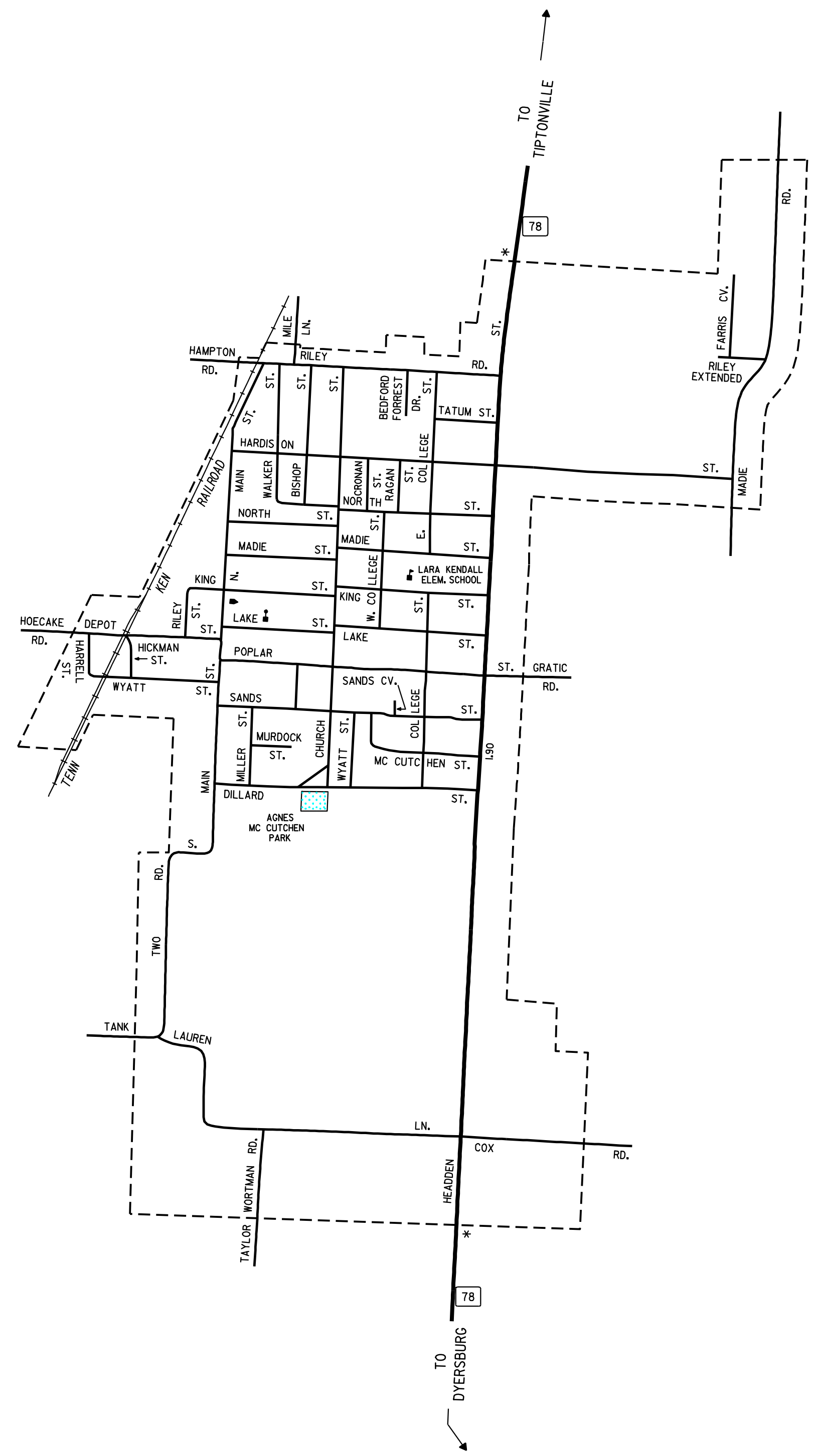
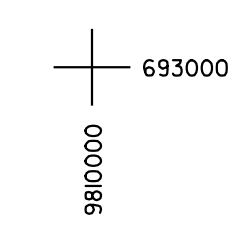
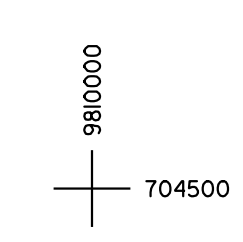
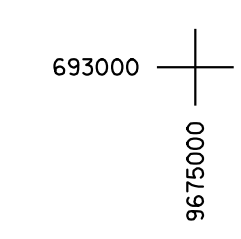
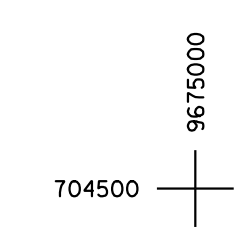

GRID TICKS BASED ON THE  
TENNESSEE COORDINATE SYSTEM  
(1927 NORTH AMERICAN DATUM)

POPULATION 1,667 (2000 CENSUS)