

EASTPORT  
1

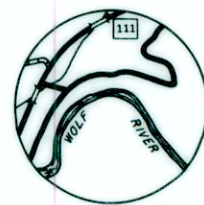

AREA S. E. OF GREEN BRIER  
2

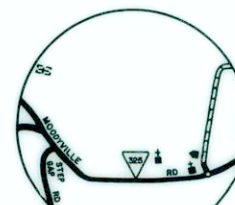

MOODYVILLE  
3

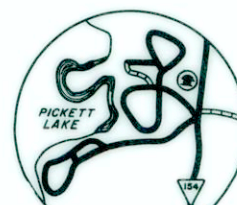

PICKETT LAKE AND VICINITY  
4

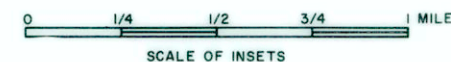

# K E N T U C K Y

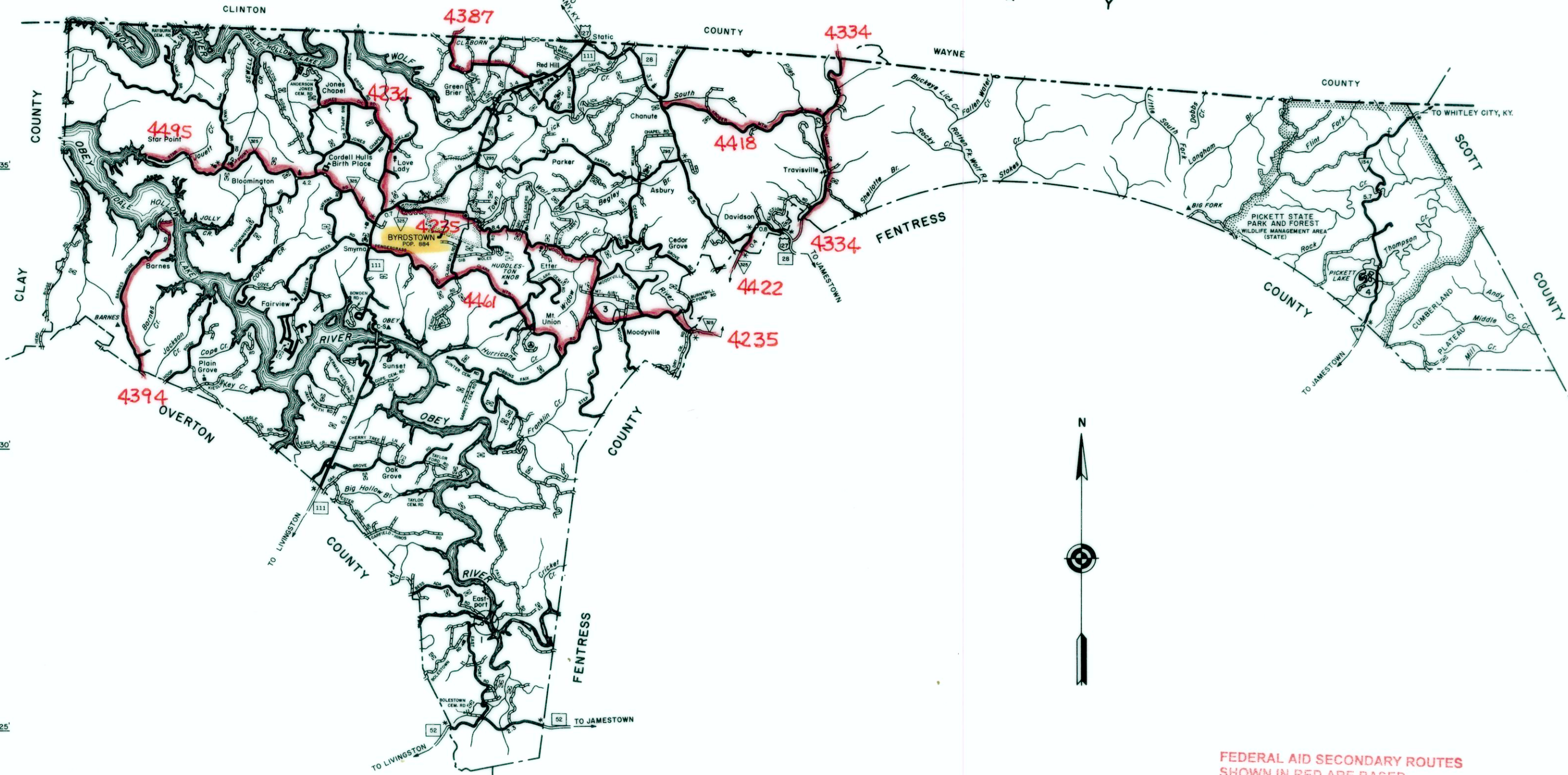

FEDERAL AID SECONDARY ROUTES SHOWN IN RED ARE BASED ON SYSTEM ROUTE INFORMATION CIRCA 1976, THE YEAR THE PROGRAM ENDED.

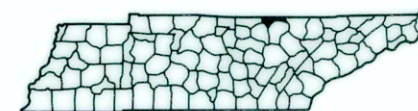

## GENERAL HIGHWAY MAP PICKETT COUNTY TENNESSEE

PREPARED BY THE  
TENNESSEE DEPARTMENT OF TRANSPORTATION  
BUREAU OF PLANNING AND DEVELOPMENT  
PLANNING DIVISION  
IN COOPERATION WITH THE  
U.S. DEPARTMENT OF TRANSPORTATION  
FEDERAL HIGHWAY ADMINISTRATION



1993

AUTHORIZATION NO. 401901936900

### LEGEND

- SCHOOL
- CHURCH
- CHURCH WITH CEMETERY
- CEMETERY
- POST OFFICE
- HOSPITAL
- TOWN HALL OR COMMUNITY CENTER
- HIGHWAY PATROL STATION
- HIGHWAY GARAGE (S-STATE, C-COUNTY)
- WEIGHT STATION
- AIRPORT, COMPLETE FACILITIES
- AIRPORT, LIMITED FACILITIES
- LANDING AREA OR STRIP
- TRIANGULATION STATION
- OBSERVATION OR LOOKOUT TOWER
- COUNTY SEAT
- OTHER CITIES AND VILLAGES
- POWER PLANT
- RADIO OR TELEVISION STATION
- DOT TO INDICATE LOCATION OF ANY CULTURAL FEATURE OUT OF PLACE
- INTERSTATE HIGHWAY MARKER
- U.S. NUMBERED HIGHWAY MARKER
- STATE HIGHWAY MARKER (FEDERAL AID PRIMARY SYSTEM)
- STATE HIGHWAY MARKER (FEDERAL AID SECONDARY SYSTEM)
- PROMINENT PEAK WITH ELEVATION
- LAKE WITH DAM
- RESERVOIR, POND OR LAKE
- LEVEE OR DYKE
- DRAINAGE CANAL
- NARROW STREAM
- WIDE STREAM
- DAM WITH LOCK
- HEAD OF NAVIGATION
- NAVIGABLE STREAM
- RAILROAD STATION
- GRADE CROSSING
- UNDERPASS-ROAD BELOW
- OVERHEAD-ROAD ABOVE
- RAILROAD TUNNEL
- HIGHWAY GRADE SEPARATION
- HIGHWAY BRIDGE-OVER 20 FEET
- FORD
- LOW WATER BRIDGE
- FREE FERRY OR TOLL FERRY
- HIGHWAY BRIDGE-LONG RIVER CROSSING (C-CONCRETE, S-STEEL, W-WOOD)
- PRIMITIVE OR UNIMPROVED ROAD
- GRADED AND DRAINED ROAD
- SOIL, GRAVEL OR STONE SURFACED ROAD
- PAVED ROAD
- DIVIDED HIGHWAY
- DISTANCE IN MILES BETWEEN DESIGNATED POINTS
- FULL CONTROL OF ACCESS
- NATIONAL PARK SERVICE HIGHWAY
- HIGHWAY INTERCHANGE
- COUNTY LINE
- STATE LINE
- MONUMENTED BOUNDARY MARKER
- INCORPORATED CITY BOUNDARY
- RESERVATION BOUNDARY

MAP RECORD	
FIELD DATA OBTAINED IN 1979	
FIELD EXAMINATION MADE IN 1983	
REVISIONS	
FEATURE	DATE
STATE HIGHWAY SYSTEM	1990
STATE HIGHWAY SYSTEM	1993

POPULATION OF PICKETT COUNTY  
4,548 (1990 CENSUS)

1 COUNTY MAP SHEET WITH  
1 SUPPLEMENTAL CITY MAP SHEET  
BYRDSTOWN

THE PICKETT COUNTY COMMISSION HAS REVIEWED AND ADOPTED THIS GENERAL HIGHWAY MAP AS THE OFFICIAL MAP FOR PICKETT COUNTY BY RESOLUTION, JUNE 21, 1983